

# TRIMO

## Efficient, Innovative, Sustainable TRIMO MODULAR SPACE SOLUTIONS

### Hospitality

Easy to set up, Trimo's modular units offer innovative solutions for all hotel and leisure requirements as well as specialized buildings for use in marinas and campsites etc. Highly adaptable and customizable, they offer investors and architects almost limitless possibilities to create bespoke solutions in terms of design, space efficiency and wellbeing as well as being a cost effective construction.

### Trimo

- One of the leading providers of modular solutions.
- 25 years of experience.
- Almost 100,000 units manufactured and supplied in more than 40 countries worldwide.
- Highly experienced engineering, production and sales teams.
- Holding ISO 9001, ISO 14001, BS OHSAS 18001 and CE certificates.

### References

- Sanitary Block and Shop, Marina Kornati, Biograd na moru, Croatia
- Vacation Camp, Lopari, Croatia
- Sanitary Block, Camp Soline, Biograd na moru, Croatia
- Motel Pelikan, Dettelbach, Germany
- Eurohotel, Pettenbach, Austria
- Sports Facility, Alpbach, Austria
- Chapel, Oslo, Norway
- Hotel, Hemsedal, Norway
- Family House, Nürnberg, Germany



Sanitary Block and Shop, Marina Kornati, Biograd na moru, Croatia



Sports Facility, Alpbach, Austria



Motel Pelikan, Dettelbach, Germany



Hotel, Hemsedal, Norway



Eurohotel, Pettenbach, Austria

## Modular Unit

### 1. Reinforced steel framework

Highest quality steel can be additionally coated and galvanized for use in the toughest climatic conditions. Steel construction is designed for easy handling and linking and also includes rainwater draining within the corner pillars.

### 2. Easy to transport and re-locate

Can be transported assembled due to special integrated vertical and horizontal reinforcements.

### 3. Windows & Doors

Standard or non-standard windows made in EU with CE mark are available. Insulation of windows as high as  $U=0.7 \text{ W/m}^2\text{K}$ .

### 4. Long term economic benefits

Can be assembled and disassembled a minimum of 3 times and can therefore be used on many consecutive projects and over a long time period.

### 5. Tailor made solutions in accordance with customer needs

## Façade Panels

### 6. Thermal and sound insulation

Using various Trimo FTV fireproof panels of 60 to 133 mm thickness, thermal conductivity values (U) as low as  $0.30 \text{ W/m}^2\text{K}$  can be guaranteed as well as an  $R_w$  sound reduction of 32 dB.

### 7. High Density Rock Wool

$100\text{-}120 \text{ kg/m}^3$  assures vertical consistency and prevents heat bridges during the complete life span of the product.

### 8. Completely fire proof solution

Walls, floors and ceilings are made of "A1" class non-combustible materials, are completely recyclable and environmental friendly. EI Fire resistance class certified (EI30 - EI120).

### 9. Various profiles and custom colours

Various faced profiles are available to meet customers' demands and any colour from the RAL colour-chart.

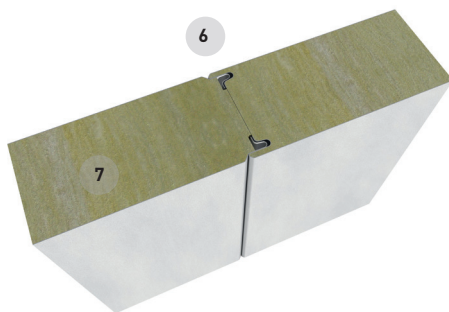
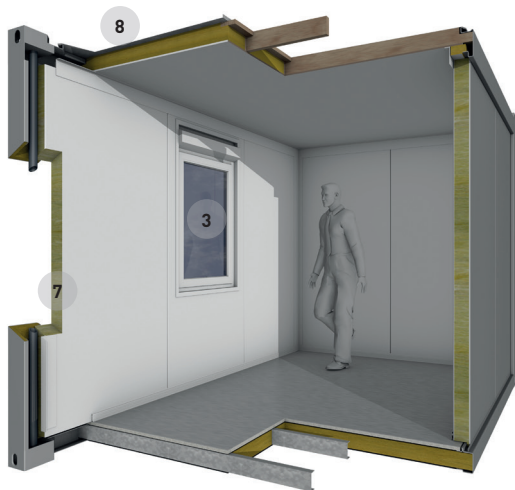

Complete sand, wind  
and water tightness



# TRIMO

TRIMO MSS D.O.O.

PRIJATELJEVA CESTA 12,  
8210 TREBNJE | SLOVENIA

T: +386 (0)7 34 83 500

E: TRIMO.MSS@TRIMO-GROUP.COM

WWW.TRIMO-GROUP.COM